

APL Smart Wireless 230 control unit



TECHNICAL FEATURES



Description

Control unit for APL Smart Wireless 230 systems.

ELECTRICAL FEATURES

Input voltage	100 ÷ 240 Vac
Output voltage (LED luminaries)	230 Vac - twilight (night only)
Output voltage (flashing lamps)	12 Vdc - adjustable timer activation (8÷25 seconds)
Output voltage (Activation devices)	12 Vdc
Predisposition public grid	12V 9Ah battery (included)
Type of synchronism	Wireless (868 MHz frequency)
Maximum distance between modules	50 m
Protection	Over-discharge cutoff; Overvoltages; Overcurrents
Insulation Class	Class II

MECHANICAL FEATURES

Operating temperature	-10 °C ÷ 55 °C
IP protection Degree	IP65
Weight	10 Kg
Dimensions	280 x 360 x 110 mm (without brackets)
Material	Steel
Fixing	Band-it, 60mm or 90mm poles brackets

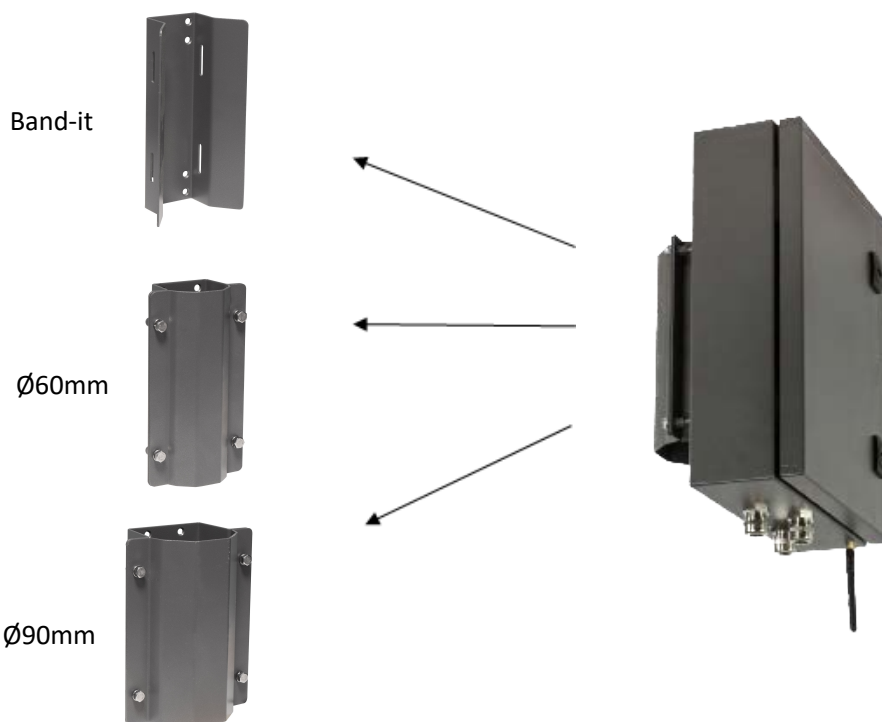

Rev. 3.0
12/03/2024

Approved TEC

Approved AQ

Version with 60 mm pole brackets

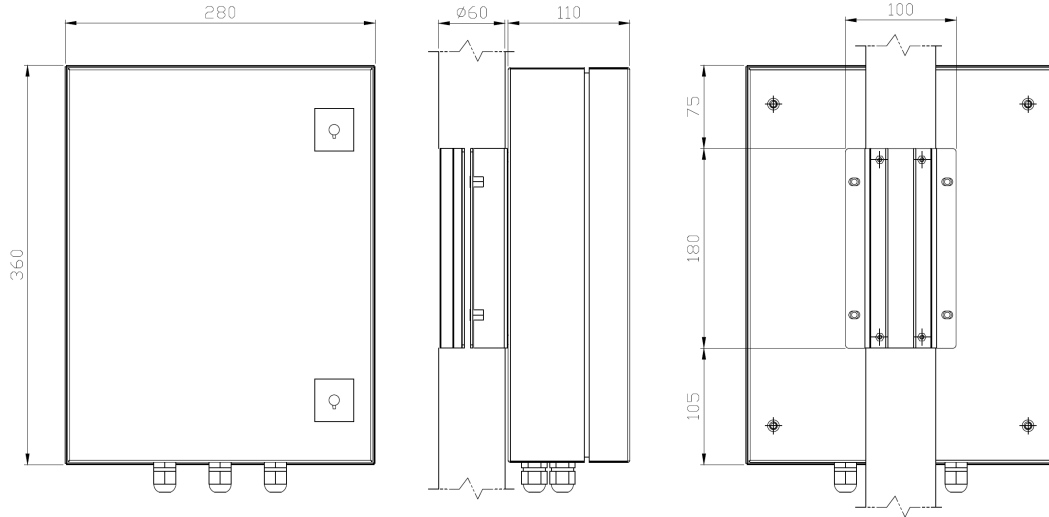

Version with 90 mm pole brackets

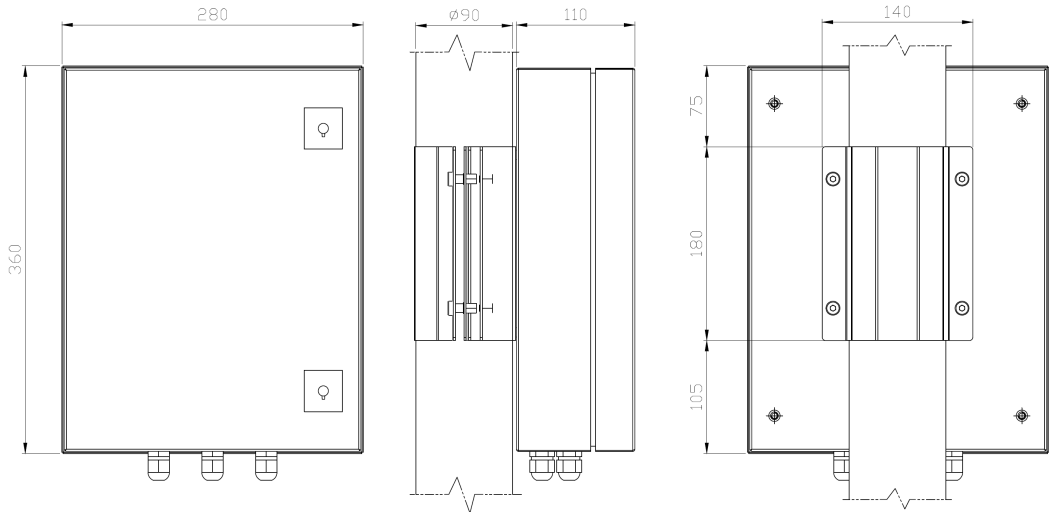

Version with Band-it pole brackets

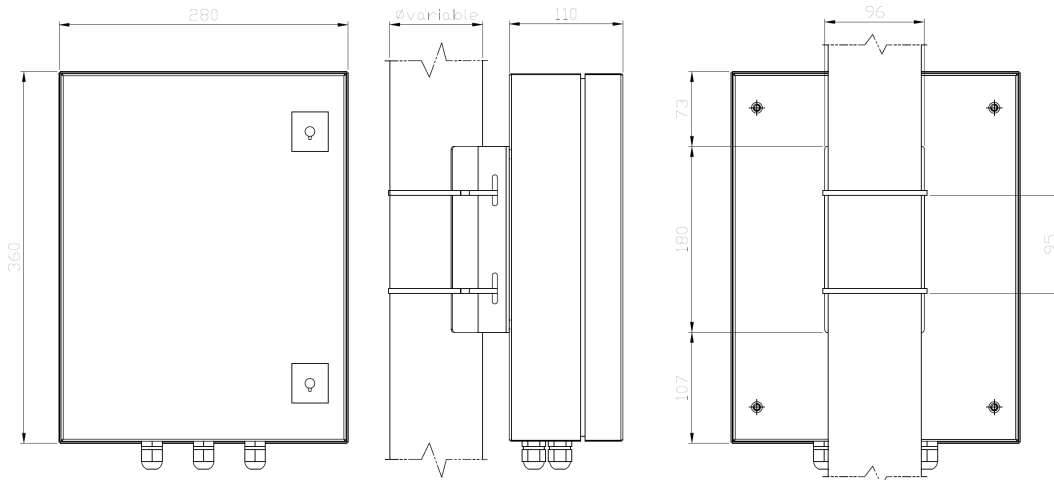

Rev. 3.0
12/03/2024

Approved TEC

Approved AQ